

NOTES:
1. DEGREASE, DEBURR, & BREAK ALL SHARP EDGES

| ITEM NO. | PART NUMBER | DESCRIPTION | QTY. |
|----------|---------------|-------------------------------------|------|
| 1 | WT100-026 | GB, K110R 2" HOLLOW 53:1 | 1 |
| 2 | WT100-027 | RATIO MULTIPLIER 4.31:1 - 143TC | 1 |
| 3 | WT102-026-575 | MTR 1.5HP 575V 1800RPM, 145TC | 1 |
| 4 | WT200-222 | PF TOP FEED BRINE, 2.5" | 1 |
| 5 | WT200-634 | HVB500G TANKw/SKIN,FULL SWEEP | 1 |
| 6 | WT295-097 | PFHT PNEUMATIC ASSEMBLY | 1 |
| 7 | WT295-218 | PFHT250, PLUMBING ASM | 1 |
| 8 | WT295-260 | CAP ASM, 3" TRI-CLAMP | 1 |
| 9 | WT295-261 | CAP ASM, 1.5" TRI-CLAMP | 1 |
| 10 | WT590-405-01 | PFHT CTRL ASM 600VAC 50kA | 1 |
| 11 | WT595-180 | PD TEMP ASM | 1 |
| 12 | WT595-185 | PF POINT LEVEL ASM | 3 |
| 13 | WT710-036 | GASKET 3" TRI-CLAMP | 1 |
| 14 | WT710-107 | GASKET, PD MANWAY, 18"DIA | 1 |
| 15 | WT803-054 | FTG 3" TRI-CLAMP CLAMP | 1 |
| 16 | WT902-021-04 | STANDOFF PAIR, 1.12" Dia x 4.88" Lg | 4 |

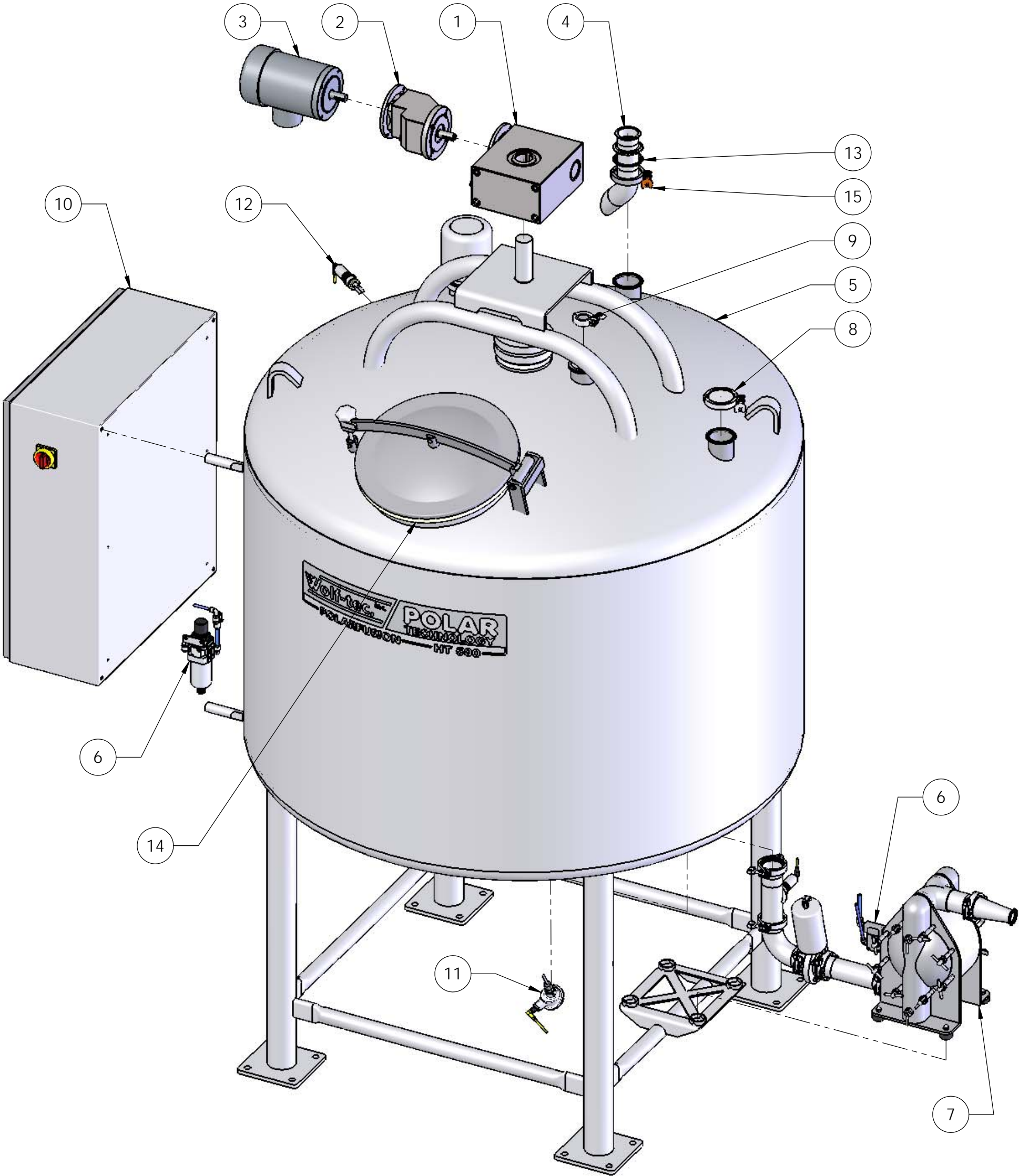

| | | | | |
|-----|-----------|-------------------------------|-----|------|
| - | 4/18/2013 | INITIAL RELEASE | JCG | - |
| REV | DATE | REVISION / CHANGE DESCRIPTION | BY | APPR |

THIS DOCUMENT AND THE DATA DISCLOSED HEREIN OR HEREWITH IS NOT TO BE REPRODUCED, USED, OR DISCLOSED IN WHOLE OR IN PART TO ANYONE WITHOUT THE PERMISSION OF WOLF-TEC INC.

| | | | |
|---|------------|--------|-----|
| UNLESS OTHERWISE SPECIFIED | | | |
| DO NOT SCALE DRAWING * BREAK ALL EDGES * | | | |
| DIMENSIONS | TOL | INCHES | MM |
| INCHES <input checked="" type="checkbox"/> | .X | .03 | .75 |
| MM <input type="checkbox"/> | .XX | .01 | .25 |
| | .XXX | .005 | .13 |
| THIRD ANGLE | FRACTIONAL | 1/64 | |
| | ANGULAR | 0-30° | |
| FINISH <input checked="" type="checkbox"/> | CONCENTRIC | 0.001 | |

| | | |
|-----------|----------|-----------|
| DRAWN | JCG | 4/18/2013 |
| CHECK | | |
| APPROVED | | |
| MATERIAL: | SEE LIST | |
| FINISH: | NONE | |

| | | | |
|---|----------------|-------------------------|-----------|
| Wolf-tec, inc. | | POLAR TECHNOLOGY | |
| 20 KIEFER LANE, KINGSTON, NEW YORK 12401 USA 845-340-9727 / FAX 845-340-9732 | | | |
| ASM/PART DESCRIPTION: 600V POLAR FUSION HOLD TANK, 500GAL | | | |
| SIZE: B | SCALE: 1:12 | DWG: PFHT500-002 | REV: - |